

**Application for a premises licence to be granted
under the Licensing Act 2003**

PLEASE READ THE FOLLOWING INSTRUCTIONS FIRST

Before completing this form please read the guidance notes at the end of the form. If you are completing this form by hand please write legibly in block capitals. In all cases ensure that your answers are inside the boxes and written in black ink. Use additional sheets if necessary.

You may wish to keep a copy of the completed form for your records.

We, Whitbread Group plc, apply for a premises licence under section 17 of the Licensing Act 2003 for the premises described in Part 1 below (the premises) and we are making this application to you as the relevant licensing authority in accordance with section 12 of the Licensing Act 2003

Part 1 – Premises details

Postal address of premises or, if none, ordnance survey map reference or description Hereford Premier Inn, Hoimer Road, Holmer	
Post town Hereford	Post code HR4 9RS

Telephone number of premises (if any)	<input style="width: 90%;" type="text"/>
Non-domestic rateable value of premises	<input style="width: 90%;" type="text" value="£279,000"/>

Part 2 - Applicant Details

Please state whether you are applying for a premises licence as

- | | | |
|---|---|-----------------------------|
| a) An individual or individuals* | Please tick ✓
<input type="checkbox"/> | please complete section (A) |
| b) a person other than an individual* | | |
| i. as a limited company | <input checked="" type="checkbox"/> | please complete section (B) |
| ii. as a partnership | <input type="checkbox"/> | please complete section (B) |
| iii. as an unincorporated association or | <input type="checkbox"/> | please complete section (B) |
| iv. other (for example a statutory corporation) | <input type="checkbox"/> | please complete section (B) |
| c) a recognised club | <input type="checkbox"/> | please complete section (B) |
| d) a charity | <input type="checkbox"/> | please complete section (B) |
| e) the proprietor of an educational establishment | <input type="checkbox"/> | please complete section (B) |
| f) a health service body | <input type="checkbox"/> | please complete section (B) |
| g) a person who is registered under Part 2 of the Care Standards Act 2000 (c14) in respect of an independent hospital | <input type="checkbox"/> | please complete section (B) |
| h) the chief officer of police of a police force in England and Wales | <input type="checkbox"/> | please complete section (B) |

* If you are applying as a person described in (a) or (b) please confirm:

Please tick yes

- I am carrying on or proposing to carry on a business which involves the use of the premises for licensable activities; or
- I am making the application pursuant to a
 - Statutory function or
 - A function discharged by virtue of Her Majesty's prerogative

(A) INDIVIDUAL APPLICANTS (fill in as applicable)

Mr Mrs Miss Ms Other title (For example, Rev)

Surname First names

Date of Birth: I am 18 years old or over Please tick

Nationality:
Where applicable (if demonstrating a right to work via the Home Office online right to work checking service), the 9-digit 'share code' provided to the applicant by that service (please see note 15 for information)

Current postal address if different from premises address

Post Town Postcode

Daytime contact telephone number

Email address (optional)

Second Individual Applicant (if applicable)

Mr Mrs Miss Ms Other title (For example, Rev)

Surname First names

Date of Birth: I am 18 years old or over Please tick

Nationality:
Where applicable (if demonstrating a right to work via the Home Office online right to work checking service), the 9-digit 'share code' provided to the applicant by that service (please see note 15 for information)

Current postal address if different from premises address

Post Town Postcode

Daytime contact telephone number

Email address (optional)

(B) OTHER APPLICANTS

Please provide name and registered address of applicant in full. Where appropriate please give any registered number. In case of a partnership or other joint nature (other than a body corporate), please give the name and address of each party concerned.

Name Whitbread Group plc
Address Whitbread Court, Houghton Hall Business Park, Porz Avenue, Dunstable, Bedfordshire, LU5 5XE
Registered number (where applicable) 29423
Description of applicant (for example, partnership, company, unincorporated association etc.) Public Limited Company
Telephone number (if any)
E-mail address (optional)

Part 3 - Operating Schedule

When do you want the premises licence to start?

Day Month Year

A	S	A	P				
---	---	---	---	--	--	--	--

If you wish the licence to be valid only for a limited period, when do you want it to end?

Day Month Year

--	--	--	--	--	--	--	--

If 5,000 or more people are expected to attend the premises at any one time, please state the number expected to attend.

N/A

Please give a general description of the premises (please read guidance note 1)

This is a new Premises Licence application to licence part of the Premier Inn site as detailed in the address provided which has existing facilities and a new food and beverage offering, as detailed on the plans submitted with the application.

It is intended that the proposed premises to be licensed will operate as a stand alone Hotel with related licensed accommodation operating under the Premier Inn brand.

The proposed site will have at ground floor level a secure entrance lobby with the Hotel reception and separate food and beverage area (usual in developments of this type) situated on the ground floor. The bedrooms (which will be unlicensed) will be located on the ground and upper floors.

It is proposed that the permitted hours for licensable activities for these premises should be :-

Monday to Sunday: 10:00 – 00:30 inclusive with the premises closing to the general public 30 minutes thereafter. However, the premises will remain open 24 hours a day to hotel residents.

This application seeks to licence the premises specifically to authorise under the Licensing Act 2003 the following activities:

1. Exhibition of a film principally non-live television or educational videos.
2. The sale of alcohol.
3. The provision of late night refreshment after 23.00

The appropriate drawings deposited with this application are :-

- Detailed Licensing Ground Floor Plan Number PI1132/AM01.

It is not anticipated that the proposed development will adversely affect the four licensing objectives.

It is understood that the site does not fall within any area of cumulative impact as adopted by the local Council but it will be noted that developments of this type in any event are not normally known to undermine the licensing objectives and particularly those of crime and disorder and public nuisance.

What licensable activities do you intend to carry on from the premises?

(Please see sections 1 and 14 of the Licensing Act 2003 and Schedule 1 and 2 to the Licensing Act 2003)

Please tick yes

Provision of regulated entertainment (please read guidance note 2)

- a) Plays (if ticking yes, fill in box A)
- b) Films (if ticking yes, fill in box B)
- c) indoor sporting events (if ticking yes, fill in box C)
- d) boxing or wrestling entertainment (if ticking yes, fill in box D)
- e) live music (if ticking yes, fill in box E)
- f) recorded music (if ticking yes, fill in box F)
- g) performances of dance (if ticking yes, fill in box G)
- h) anything of a similar description to that falling within (e), (f) or (g) (if ticking yes, fill in box H)

Provision of late night refreshment (if ticking yes, fill in box I)

Supply of alcohol (if ticking yes, fill in box J)

In all cases complete boxes K, L and M

A

Plays Standard days and timings (please read guidance note 7)			Will the performance of a play take place indoors or outdoors or both – please tick {Y} (please read guidance note 3).	Indoors	
Day	Start	Finish		Outdoors	
Mon			Please give further details here (please read guidance note 4)	Both	
Tue					
Wed			State any seasonal variations for performing plays (please read guidance note 5)		
Thur					
Fri			Non standard timings. Where you intend to use the premises for the performance of plays at different times to those listed in the column on the left, please list (please read guidance note 6)		
Sat					
Sun					

B

Films Standard days and timings (please read guidance note 7)			Will the exhibition of films take place Indoors or outdoors or both – please tick {Y}(please read guidance note 3).	Indoors	✓
Day	Start	Finish		Outdoors	
				Both	
Mon	10:00	00:30	Please give further details here (please read guidance note 4) As stated in Part 3 above. There shall be no films shown to a close seated audience		
Tue	10:00	00:30			
Wed	10:00	00:30	State any seasonal variations for the exhibition of films (please read guidance note 5) N/A – save as below		
Thur	10:00	00:30			
Fri	10:00	00:30	Non standard timings. Where you intend to use the premises for the exhibition of films at different times to those listed in the column on the left, please list (please read guidance note 6) When hours for sale of alcohol are extended hereunder these hours are also extended (see box J below)		
Sat	10:00	00:30			
Sun	10:00	00:30			

C

Indoor sporting events Standard days and timings (please read guidance note 7)			Please give further details (please read guidance note 4)
Day	Start	Finish	
Mon			State any seasonal variations for indoor sporting events (please read guidance note 5)
Tue			
Wed			
Thur			Non standard timings. Where you intend to use the premises for indoor sporting events at different times to those listed in the column on the left, please list (please read guidance note 6)
Fri			
Sat			
Sun			

D

Boxing or wrestling entertainment Standard days and timings (please read guidance note 7)			Will the boxing or wrestling entertainment take place indoors or outdoors or both – please tick {Y}(please read guidance note 3).	Indoors		
Day	Start	Finish		Outdoors		
Mon			Please give further details here (please read guidance note 4)	Both		
Tue						
Wed				State any seasonal variations for boxing or wrestling entertainment (please read guidance note 5)		
Thur						
Fri				Non standard timings. Where you intend to use the premises for boxing or wrestling entertainment at different times to those listed in the column on the left, please list (please read guidance note 6)		
Sat						
Sun						

E

Live music Standard days and timings (please read guidance note 7)			Will the performance of live music take place indoors or outdoors or both – please tick {Y}(please read guidance note 3).	Indoors		
Day	Start	Finish		Outdoors		
Mon			Please give further details here (please read guidance note 4)	Both		
Tue						
Wed				State any seasonal variations for the performance of live music (please read guidance note 5)		
Thur						
Fri				Non standard timings. Where you intend to use the premises for the performance of live music at different times to those listed in the column on the left, please list (please read guidance note 6)		
Sat						
Sun						

F

Recorded music Standard days and timings (please read guidance note 7)			Will the playing of recorded music take place indoors or outdoors or both - please tick {Y} (please read guidance note 3).	Indoors	
Day	Start	Finish		Outdoors	
				Both	
Mon			Please give further details here (please read guidance note 4)		
Tue					
Wed			State any seasonal variations for playing recorded music (please read guidance note 5)		
Thur					
Fri			Non standard timings. Where you intend to use the premises for the playing of recorded music entertainment at different times to those listed in the column on the left, please list (please read guidance note 6)		
Sat					
Sun					

G

Performances of dance Standard days and timings (please read guidance note 7)			Will the performance of dance take place indoors or outdoors or both - please tick {Y} (please read guidance note 3).	Indoors	
Day	Start	Finish		Outdoors	
				Both	
Mon			Please give further details here (please read guidance note 4)		
Tue					
Wed			State any seasonal variations for the performance of dance (please read guidance note 5)		
Thur					
Fri			Non standard timings. Where you intend to use the premises for the performance of dance entertainment at different times to those listed in the column on the left, please list (please read guidance note 6)		
Sat					
Sun					

H

Anything of a similar description to that falling within (e), (f) or (g) Standard days and timings (please read guidance note 7)			Please give a description of the type of entertainment you will be providing	
Day	Start	Finish	Will this entertainment take place indoors or outdoors or both – please tick {Y} (please read guidance note 3).	Indoors
				Outdoors
				Both
Mon			Please give further details here (please read guidance note 4)	
Tue				
Wed				
Thur			State any seasonal variations for entertainment of a similar description to that falling within (e), (f) or (g) (please read guidance note 5)	
Fri				
Sat				
Sun			Non standard timings. Where you intend to use the premises for the entertainment of similar description to that falling within (e), (f) or (g) at different times to those listed in the column on the left, please list (please read guidance note 6)	

I

Late night refreshment Standard days and timings (please read guidance note 7)			Will the provision of late night refreshment take place indoors or outdoors or both – please tick {Y} (please read guidance note 3).		Indoors		
Day	Start	Finish	Please give further details here (please read guidance note 4)	Outdoors			
				Both			√
Mon	23:00	00:30		To allow the provision of hot food and drink for consumption on and of the premises at the Manager's discretion and in the areas identified.			
Tue	23:00	00:30					
Wed	23:00	00:30					
Thur	23:00	00:30	N/A - save as below				
Fri	23:00	00:30	Non standard timings. Where you intend to use the premises for the provision of late night refreshment at different times, to those listed in the column on the left, please list (please read guidance note 6)				
Sat	23:00	00:30					
Sun	23:00	00:30					
			When hours for sale of alcohol are extended hereunder these hours are also extended (see box J below)				

J

Supply of alcohol Standard days and timings (please read guidance note 7)			Will the supply of alcohol be for consumption (Please tick box Y) (please read guidance note 8)	On the premises	
				Off the premises	
Day	Start	Finish		Both	✓
Mon	10:00	00:30	State any seasonal variations for the supply of alcohol (please read guidance note 5)		
Tue	10:00	00:30			
Wed	10:00	00:30			
Thur	10:00	00:30			
Fri	10:00	00:30	Non-standard timings. Where you intend to use the premises for the supply of alcohol at different times to those listed in the column on the left, please list (please read guidance note 6)		
Sat	10:00	00:30			
Sun	10:00	00:30	To extend the proposed hours on New Year's Eve to New Year's Eve - terminal hour as proposed being 00:30 on 2 nd January.		
			The premises shall remain open to permit the sale of alcohol to hotel residents 24 hours a day.		

State the name and details of the individual whom you wish to specify on the licence as premises supervisor

Name: Keshia Melisa Simpson
Date of Birth: [REDACTED]
Address: [REDACTED]
Postcode: [REDACTED]
Personal Licence number (if known): PER1431
Issuing Licensing authority (if known): Wolverhampton Council

K

Please highlight any adult entertainment or services, activities, other entertainment or matters ancillary to the use of the premises that may give rise to concern in respect of children (please read guidance note 9)

NONE save for the presence of AWP machines the use of which is not permitted by persons under the age of 18

L

Hours premises are open to the public Standard days and timings (please read guidance note 7)			State any seasonal variation (please read guidance note 5)
Day	Start	Finish	
Mon	06:00	01:00	<p>Non standard timings. Where you intend to use the premises to be open to the public at different times from those listed in the column on the left, please list (please read guidance note 6)</p> <p>The premises shall remain open 24 hours a day for hotel residents.</p> <p>For non-residents, the premises will close 30 minutes after the end of the non-standard timings identified in box J above.</p>
Tue	06:00	01:00	
Wed	06:00	01:00	
Thur	06:00	01:00	
Fri	06:00	01:00	
Sat	06:00	01:00	
Sun	06:00	01:00	

M

Describe the steps you intend to take to promote the four licensing objectives:

a) General – all four licensing objectives (b, c, d, e) (please read guidance note 10)

We have undertaken our own risk assessment to propose the following steps:-

The steps which we have identified in relation to the four licensing objectives are listed below.

b) The prevention of crime and disorder

No further risks have been identified which need to be addressed, save as below

1. The use of door staff will be risk assessed on an ongoing basis by the licence holder of premises supervisor. Where engaged, door staff shall be licensed by the Security Industry Authority.
2. Staff will receive training on matters concerning underage sales, drugs policies and operating procedures.
3. There shall be a zero tolerance policy in relation to drugs at the premises and there shall be regular checks by management to prevent the use of drugs by patrons. Drugs seized shall be stored securely and handed to the police.
4. The premises shall operate a proof of age scheme and will require photographic identification from any person who appears to be under the age of 21 years.
5. The management of the premises will liaise with police on issues of local concern or disorder.
6. CCTV will be installed with recording facilities such recordings shall be retained for a period of 31 days and made available within a reasonable time upon request by the police, such as to cover the main entrance to the premises.

There shall be no drinks promotions at the premises which are inconsistent with the need to promote responsible drinking.

c) Public safety

No further risks have been identified which need to be addressed, save as below

1. The premises will have adequate safety and fire fighting equipment and such equipment will be maintained in good operational order.

2. Staff will be trained on matters of safety, evacuation and use of emergency equipment as required.
3. Spillages and breakages will be removed as soon as possible to reduce the risk to patrons and staff.
4. Fire Exits and means of escape shall be kept clear and in good operational condition.

d) The prevention of public nuisance

No further risks have been identified which need to be addressed, save as below

1. Where appropriate, prominent, clear and legible notices shall be displayed at all exits requesting the public respect the needs of local residents and to leave the premises and area quietly.
2. Patrons will be encouraged by staff to leave quietly and respect the interests of the occupiers of any nearby noise sensitive premises, Where appropriate the licensee or a suitable staff member will monitor patrons leaving at the closing time.
3. Noise or vibration shall not emanate from the premises so as to cause a nuisance to nearby properties.
4. Contact numbers for local taxi firm(s) shall be kept at the premises and made available to patrons requiring a taxi.

e) The protection of children from harm

1. The restrictions set out in the Licensing Act 2003 will apply. No unusual or additional risks of harm to children have been identified.
2. No films or videos of any description will be shown so that they can be viewed by persons under the age of any applicable BBFC/Local Authority certification.
3. Children under the age of 16 shall not be permitted to enter the premises after 21:00 unless dining with an adult or attending a pre booked function or resident in the hotel.
4. There shall be adequate controls in place including staff training to safeguard against the sale of alcohol to persons under 18 years.
5. The premises supervisor or appointed staff member shall ensure that when children are admitted to the premises their presence is not inconsistent with the style of operation of the premises at that time and the licensable activities that are being carried out.
5. Policies in relation to children shall be adequately communicated to patrons by staff or through appropriate signage.

Checklist:

Please tick to indicate agreement

- I have made or enclosed payment of the fee
- I have enclosed the plan of the premises
- I have sent copies of this application and the plan to responsible authorities and others where applicable
- I have enclosed the consent form completed by the individual I wish to be premises supervisor, if applicable
- I understand that I must now advertise my application
- I understand that if I do not comply with the above requirements my application will be rejected
- {Applicable to all individual applicants, including those in a partnership which is not a limited liability partnership, but not companies or limited liability partnerships} I have included documents demonstrating my entitlement to work in the United Kingdom or my share code issued by the Home Office online right to work checking service (please read note 15).

IT IS AN OFFENCE, UNDER SECTION 158 OF THE LICENSING ACT 2003, TO MAKE A FALSE STATEMENT IN OR IN CONNECTION WITH THIS APPLICATION. THOSE WHO MAKE A FALSE STATEMENT MAY BE LIABLE ON SUMMARY CONVICTION TO A FINE OF ANY AMOUNT.

IT IS AN OFFENCE UNDER SECTION 24B OF THE IMMIGRATION ACT 1971 FOR A PERSON TO WORK WHEN THEY KNOW, OR HAVE REASONABLE CAUSE TO BELIEVE, THAT THEY ARE DISQUALIFIED FROM DOING SO BY REASON OF THEIR IMMIGRATION STATUS. THOSE WHO EMPLOY AN ADULT WITHOUT LEAVE OR WHO IS SUBJECT TO CONDITIONS AS TO EMPLOYMENT WILL BE LIABLE TO A CIVIL PENALTY UNDER SECTION 15 OF THE IMMIGRATION, ASYLUM AND NATIONALITY ACT 2006 AND PURSUANT TO SECTION 21 OF THE SAME ACT, WILL BE COMMITTING AN OFFENCE WHERE THEY DO SO IN THE KNOWLEDGE, OR WITH REASONABLE CAUSE TO BELIEVE, THAT THE EMPLOYEE IS DISQUALIFIED.

Part 4 – Signatures (please read guidance note 11)

Signature of applicant or applicant’s solicitor or other duly authorised agent. (Please read guidance note 11). **If signing on behalf of the applicant please state in what capacity.**

Declaration	<ul style="list-style-type: none"> • {Applicable to individual applicants only, including those in a partnership which is not a limited liability partnership} I understand I am not entitled to be issued with a licence if I do not have the entitlement to live and work in the UK (or if I am subject to a condition preventing me from doing work relating to the carrying on of a licensable activity) and that my licence will become invalid if I cease to be entitled to live and work in the UK (please read guidance note 15). • The DPS named in this application form is entitled to work in the UK (and is not subject to conditions preventing him or her from doing work relating to a licensable activity) and I have seen a copy of his or her proof of entitlement to work, or have conducted an online right to work check using the Home Office online right to work checking service which confirmed their right to work (please see note 15)
--------------------	---

For joint applications signature of 2nd applicant or 2nd applicant’s solicitor or other authorised agent. (Please read guidance note 13). **If signing on behalf of the applicant please state in what capacity.**

Signature: John Gaunt & Partners

Date:

Capacity: Solicitors

Contact name (where not previously given) and address for correspondence associated with this application (please read guidance note 14)

**John Gaunt & Partners
Omega Court
372 Cemetery Road**

Post town
Sheffield

Post code
S11 8FT

Telephone number (if any) **0114 2668664**

If you would prefer us to correspond with you by e-mail, your e-mail address (optional)
TShield@john-gaunt.co.uk

Notes for Guidance

1. Describe the premises, for example the type of premises, its general situation and layout and any other information which could be relevant to the licensing objectives. Where your application includes off-supplies of alcohol and you intend to provide a place for consumption of these off-supplies, you must include a description of where the place will be and its proximity to the premises.
2. In terms of specific regulated entertainments please note that:
 - **Plays:** no licence is required for performances between 08:00 and 23.00 on any day, provided that the audience does not exceed 500.
 - **Films:** no licence is required for 'not-for-profit' film exhibition held in community premises between 08.00 and 23.00 on any day provided that the audience does not exceed 500 and the organiser (a) gets consent to the screening from a person who is responsible for the premises; and (b) ensures that each such screening abides by age classification ratings.
 - **Indoor sporting events:** no licence is required for performances between 08.00 and 23.00 on any day, provided that the audience does not exceed 1000.
 - **Boxing or Wrestling Entertainment:** no licence is required for a contest, exhibition or display of Greco-Roman wrestling, or freestyle wrestling between 08.00 and 23.00 on any day, provided that the audience does not exceed 1000. Combined fighting sports – defined as a contest, exhibition or display which combines boxing or wrestling with one or more martial arts – are licensable as a boxing or wrestling entertainment rather than an indoor sporting event.
 - **Live music:** no licence permission is required for:
 - a performance of unamplified live music between 08.00 and 23.00 on any day, on any premises.
 - a performance of amplified live music between 08.00 and 23.00 on any day on premises authorised to sell alcohol for consumption on those premises, provided that the audience does not exceed 500.
 - a performance of amplified live music between 08.00 and 23.00 on any day, in a workplace that is not licensed to sell alcohol on those premises, provided that the audience does not exceed 500.
 - a performance of amplified live music between 08.00 and 23.00 on any day, in a church hall, village hall, community hall, or other similar community premises, that is not licensed by a premises licence to sell alcohol, provided that (a) the audience does not exceed 500, and (b) the organiser gets consent for the performance from a person who is responsible for the premises.
 - a performance of amplified live music between 08.00 and 23.00 on any day, at the non-residential premises of (i) a local authority, or (ii) a school, or (iii) a hospital, provided that (a) the audience does not exceed 500, and (b) the organiser gets consent for the performance on the relevant premises from: (i) the local authority concerned, or (ii) the school or (iii) the health care provider for the hospital.
 - **Recorded Music:** no licence permission is required for:
 - any playing of recorded music between 08.00 and 23.00 on any day on premises authorised to sell alcohol for consumption on those premises, provided that the audience does not exceed 500.
 - any playing of recorded music between 08.00 and 23.00 on any day, in a church hall, village hall, community hall, or other similar community premises, that is not licensed by a premises licence to sell alcohol, provided that (a) the audience does not exceed 500, and (b) the organiser gets consent for the performance from a person who is responsible for the premises.
 - any playing of recorded music between 08.00 and 23.00 on any day, at the non-residential premises of (i) a local authority, or (ii) a school, or (iii) a hospital, provided that (a) the audience does not exceed 500, and (b) the organiser gets consent for the performance on the

CONSENT OF INDIVIDUAL TO BEING SPECIFIED AS PREMISES SUPERVISOR

I, **Keshia Melissa Simpson**, of [REDACTED]

[REDACTED] hereby confirm that I give my consent to

be specified as the designated premises supervisor in relation to the application for ~~variation of~~ the premises licence by **Whitbread Group PLC**

relating to an application for a premises licence for the **PREMIER INN**

HOUMEN ROAD HOUMEN WY4 9RS

and any premises licence to be granted or varied in respect of this

application made by **Whitbread Group PLC** concerning the supply of

alcohol at the..... **PREMIER INN HOUMEN RD**

HOUMEN WY4 9RS

I also confirm that I am entitled to work in the United Kingdom and am applying for, intend to apply for or currently hold a personal licence, details of which I set out below.

Personal Licence number: **PER1431**

Personal Licence issuing authority: **City of Wolverhampton**

Date of birth: **21st November 1988**

Place of birth: **Wolverhampton**

Nationality: **British**

Mobile/contact telephone number: **07802 773 288**

[REDACTED]
Name (please print): **Keshia Melissa Simpson**

Date: **24/07/2024**

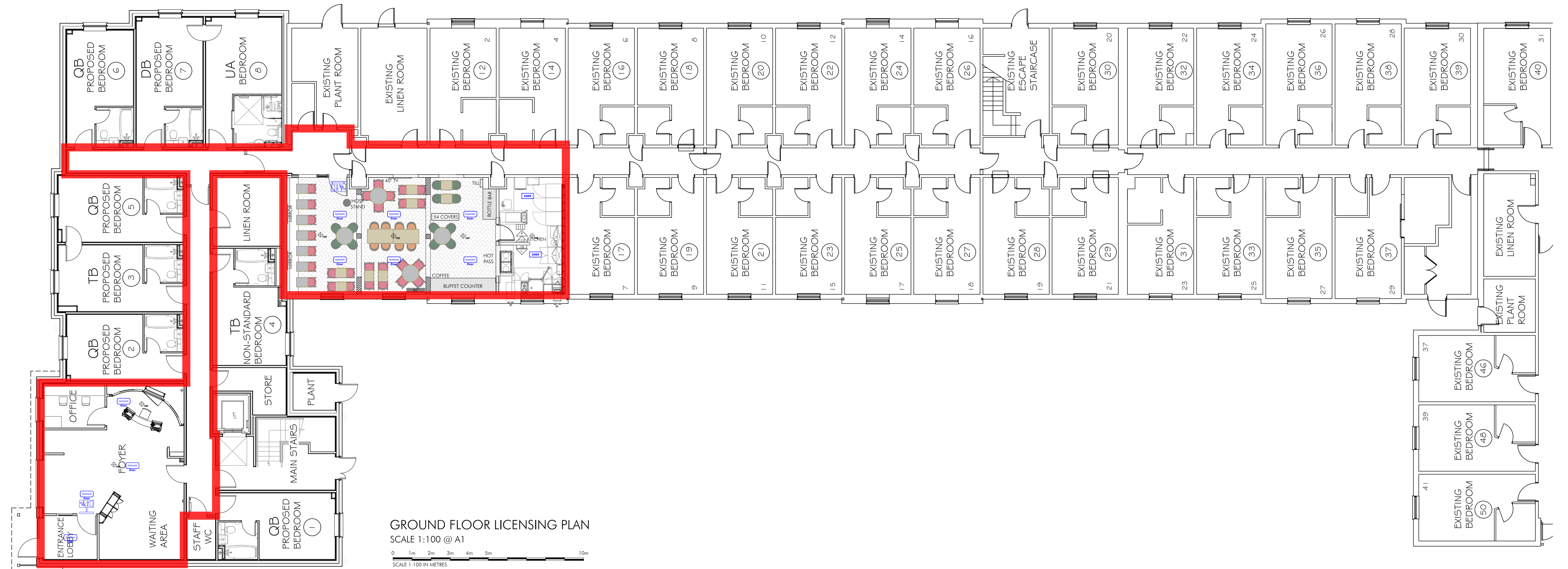

GROUND FLOOR LICENSING PLAN
SCALE 1:100 @ A1
SCALE 1:100 IN METRES

FIRE ALARM SYMBOLS	
	FIRE ALARM PANEL
	HEAT DETECTOR (RATE OF RISE)
	MULTI SENSOR
	COMBINED MULTI-SENSOR AND SOUNDER BASE
	COMBINED MULTI-SENSOR SOUNDER BASE AND FLASHING BEACON (IN UA ROOMS & 10% STANDARD)
	MANUAL CALL POINT
	EMERGENCY GAS SHUT-OFF BUTTON
	FLASHING BEACON

NOTES:
EXISTING EMERGENCY LIGHTING TO CORRIDORS AND PUBLIC AREAS INSTALLED IN ACCORDANCE WITH BS5266.
EXISTING FIRE ALARM SYSTEM TO HOTEL INSTALLED IN ACCORDANCE WITH BS5839.

SMALL POWER DISTRIBUTION & LUMINAIRES SYMBOLS	
	THORN 2D 16W POLYCARBONATE LUMINAIRE 28W TO STAIRS (E-DENOTES COMBINED 3 HOUR NON-MAINTAINED EMERGENCY)
	WALL MOUNTED FITTING (E-DENOTES COMBINED 3 HOUR NON-MAINTAINED EMERGENCY)
	CORRIDOR CEILING MOUNTED BULKHEAD FITTINGS WITH 3 HOUR (NON-MAINTAINED EMERGENCY)
	CENTRAL STAIR WELL WALL MOUNTED LIGHT FITTING (WITH 3 HOUR NON-MAINTAINED EMERGENCY)

CONTRACTOR SUPPLIED EMERGENCY LUMINAIRES SYMBOLS	
	PUBLIC CORRIDORS - VENTILUX VANTAGE VAM3/FBCR RECESSED OVERDOOR LUMINAIRE 3 HOUR MAINTAINED FITTING CHROME c/w LEGEND
	RESTAURANT / RECEPTION - RECESSED LUMINAIRE 3 HOUR NON-MAINTAINED FITTING WHITE
	BACK OF HOUSE - JSB ZETA 1 1 ZE/3/ICEL SURFACE MOUNTED LUMINAIRE 3 HOUR NON-MAINTAINED FITTING
	JSB AG8/3M/ICEL SURFACE MOUNTED LUMINAIRE 3 HOUR IP65 RATED MAINTAINED FITTING
	BACK OF HOUSE - VENTILUX ELLUX EMX3/FB SURFACE MOUNTED LUMINAIRE 3 HOUR MAINTAINED FITTING WHITE c/w LEGEND
	RESTAURANT / RECEPTION - VENTILUX GLADE GDM3/FBCR CEILING MOUNTED LUMINAIRE 3 HOUR MAINTAINED FITTING CHROME c/w LEGEND

DISABLED ALARM SYSTEM SYMBOLS	
	DISABLED ALARM PULL SWITCH
	DISABLED ALARM INDICATOR
	STAND ALONE LOOP SOUNDER / BEACON
	DISABLED REFUGE INTERCOM
	DISABLED ALARM INDICATOR PANEL

FIRE FIGHTING EQUIPMENT	
	6 LITRE AFFF FOAM EXTINGUISHER
	6 LITRE POWDER ABC FIRE EXTINGUISHER
	2KG Co2 EXTINGUISHER
	WET CHEMICAL EXTINGUISHER
	FIRE BLANKET

LICENSING PLAN

ALLISON PIKE

ARCHITECTS & DESIGNERS

7 Buxton Road West, Disley, Stockport, Cheshire, SK12 2AE. Telephone: 01663 763000
Website: www.allisonpike.com. Facsimile: 01663 766772
Email: studio@allisonpike.com

© Allison Pike Partnership Limited.

PROJECT: PREMIRE INN HEREFORD

TITLE: GROUND FLOOR LICENSING PLAN

SCALE: 1:100 @ A1

JOB No	DRAWING No	REV
PI1132	AM 01	//

BN	DRAWN	20/05/24	VER
DRAWN	REVISION	DATE	